

Big Creek Design Group
design | planning | project management

PO Box 11 Polk City, Iowa 50226
515.480.4088 www.BigCreekDesignGroup.com

CIVIL ENGINEER
HGM Associates Inc.
640 First Avenue
Council Bluffs, IA 51501-6427
Office 715-252-9499

LANDSCAPE ARCHITECT

STRUCTURAL ENGINEER

MECHANICAL ENGINEER

ELECTRICAL ENGINEER

GENERAL CONTRACTOR

SEAL / LOGO

PROJECT NAME:
New Worship Center for:

St Patrick Catholic Church
COUNCIL BLUFFS, IOWA

DRAWING ISSUE INFORMATION:
ISSUE FOR: FINAL OWNER REVIEW
ISSUE DATE: 05.06.2013

MARK DATE DESCRIPTION

MANAGEMENT INFORMATION:

PROJECT NO.: 2012.013

CAD DWG FILE: FLOOR PLAN

PRINCIPAL IN CHARGE: PROJECT ARCHITECT:

DRAWN BY: CHECKED BY:

© 2013 BIG CREEK DESIGN GROUP
THESE DOCUMENTS HAVE BEEN PREPARED SPECIFICALLY FOR THE PROJECT REFERENCED ABOVE. THEY ARE NOT TO BE USED ON OTHER PROJECTS OR IN LOCATIONS OTHER THAN SPECIFIED WITHOUT THE WRITTEN APPROVAL AND PARTICIPATION OF BIG CREEK DESIGN GROUP.

SHEET TITLE:
PHASE ONE
FLOOR PLAN
MINIMUM SCOPE

SHEET NO.:

A101-C

X

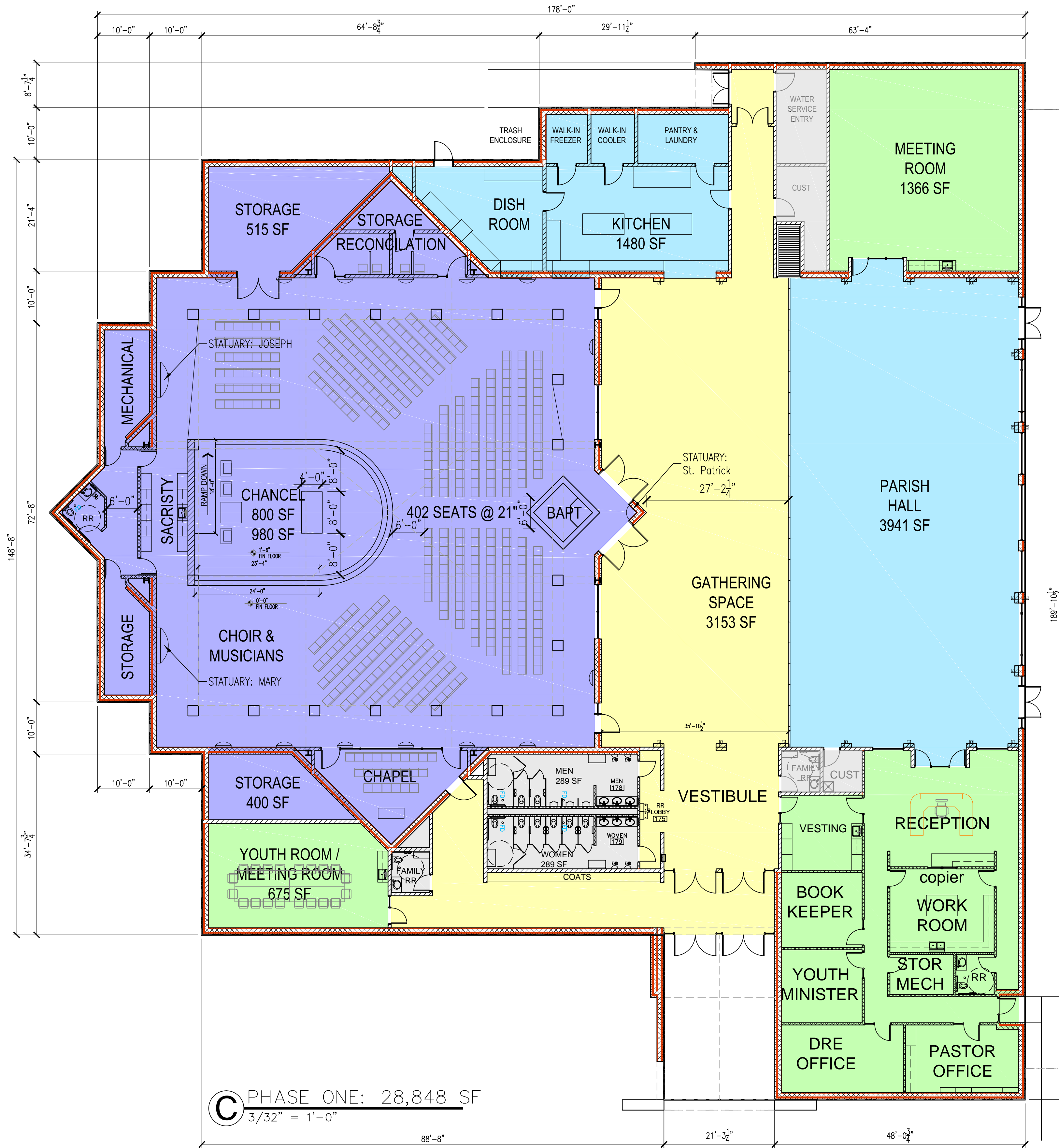

C PHASE ONE: 28,848 SF
3/32" = 1'-0"

ESTIMATED CONSTRUCTION COST:
MAY 2014: \$5,913,840
ADD 5% PER YEAR FOR INFLATION
Updated 06-09-2013

File:Z:\BCDG-Projects\2012.013 - St. Patrick's Catholic Church - Council Bluffs\DWG\A101.dwg_OWNER
Plotter:BLI1000AM PDF_Plot Date:6/9/2013 2:56:15 PM Save Date:6/9/2013 11:49 AM